

## GTS-80

### 3-Layer Global Transmission Sleeve

#### Product Description

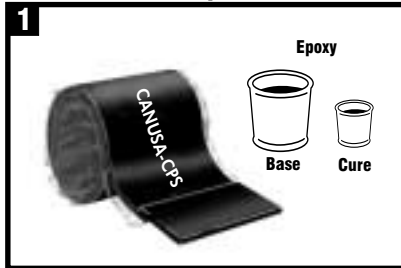

GTS-80 Global Transmission Sleeves are shipped pre-cut with a pre-attached CLH closure. Bulk quantities are also available. The sleeve adhesive is protected from contamination by an inner liner. The joint completion system may also use an epoxy primer.

#### Flame Intensity & Torch Size

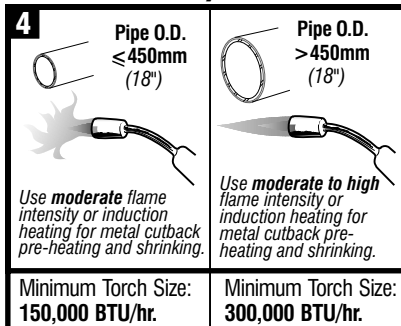

Canusa recommends the use of induction or infrared heating equipment for pipe sizes greater than 760mm (30") O.D.

#### Storage & Safety Guidelines

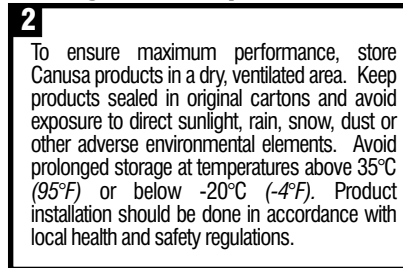

To ensure maximum performance, store Canusa products in a dry, ventilated area. Keep products sealed in original cartons and avoid exposure to direct sunlight, rain, snow, dust or other adverse environmental elements. Avoid prolonged storage at temperatures above 35°C (95°F) or below -20°C (-4°F). Product installation should be done in accordance with local health and safety regulations.

#### Surface Preparation

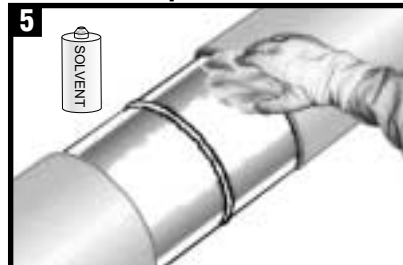

Ensure that the mainline coating edges are beveled to 30° minimum. If there is the presence of oil, grease, or other surface contaminants; clean the exposed steel and adjacent pipe coating with an approved solvent cleanser.

#### Equipment List

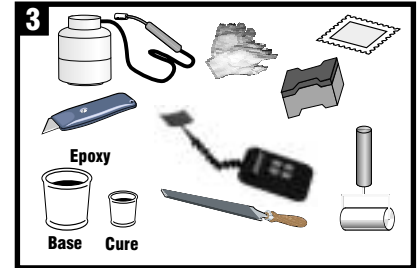

Propane tank, hose, torch & regulator  
Appropriate tools for surface abrasion  
Epoxy application accessories & wet film thickness gauge  
Knife, roller, rags & Canusa approved solvent cleanser  
Digital thermometer with suitable probe  
Standard safety equipment: gloves, goggles, hard hat, etc.

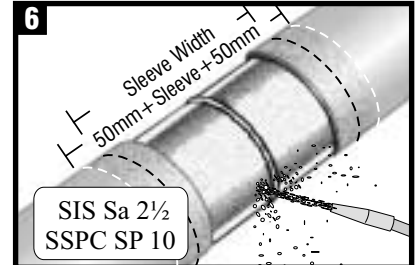

Warm the joint area to 40-50°C (104-120°F) before grit blasting. During high winds or cold ambient conditions (below 15°C (59°F)) pre-warm the joint area to 70°C (158°F) before grit blasting. Thoroughly clean the weld area with a sand or grit blaster to "near white metal" SIS Sa 2½ or equivalent. Abrade the mainline coating adjacent to the weld area to a distance 50mm (2") beyond the sleeve width.

#### Epoxy Primer

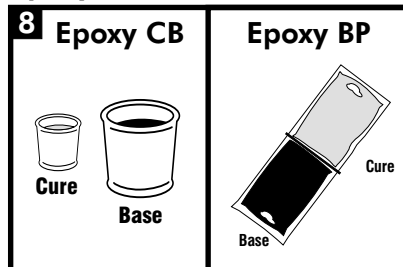

Follow the Preparation, Mixing and Application instructions provided with the supplied Canusa Epoxy Pack. For bulk quantities: mix the primer cure with the primer base (4 parts base to 1 part cure by volume). Stir for a minimum of 30 seconds to assure uniform mixture.

#### Epoxy Primer Application

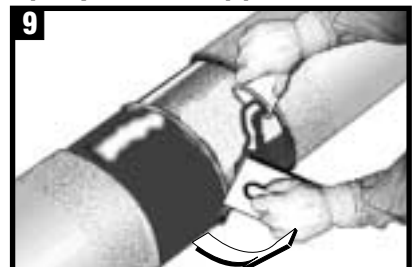

Apply mixed epoxy to a uniform specified thickness of 4-6 mils (100-150 microns) on all exposed bare metal plus 10mm (0.5") onto the adjacent pipe coating using the applicator pads as supplied or an approved tool. Do not apply the epoxy to the mainline coating.

#### Pre-Heat

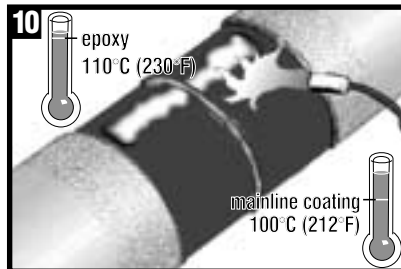

Preheat the epoxy to a temperature of 110°C (230°F) and the abraded mainline coating to be covered by the sleeve to a minimum of 100°C (212°F) with the appropriate propane torch, induction heating or infrared heating equipment. **Do not use an intense flame on the mainline coating.** If a film develops on the mainline coating because of preheat, use a surface abrasion tool to remove it.

#### Sleeve Installation



**Check the temperature to ensure the preheat has been obtained on the entire pipe circumference.** This preheat will substantially cure the epoxy and ensure proper flow and bonding of the sleeve adhesive. Ensure that the epoxy primer is dry to the touch prior to sleeve installation.



Partially remove the release liner [approximately 1 metre (3') from the edge] from the corner trimmed sleeve edge.

## Sleeve Installation Cont'd

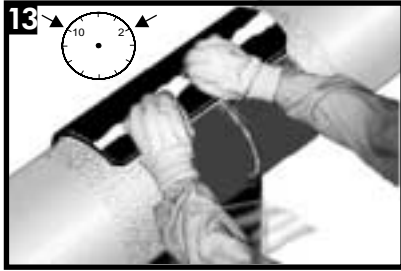

Place the underlap of the sleeve onto the joint, centering the sleeve such that the sleeve overlap is positioned at either the 10 or 2 o'clock position. Press the underlap firmly into place and use a roller to work out any trapped air. Feed the remaining length of sleeve under the pipe.

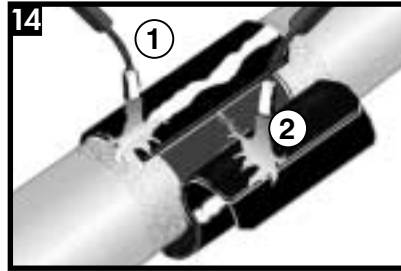

Remove the remaining sleeve release liner and wrap the sleeve loosely around the pipe, ensuring the appropriate overlap.  
Before finishing wrapping the sleeve:  
1. heat the backing side of the underlap until the backing starts to recover. Then use a roller to secure the underlap to the pipe.  
2. gently heat the green-yellow coloured adhesive side of the closure seal until it appears glossy.

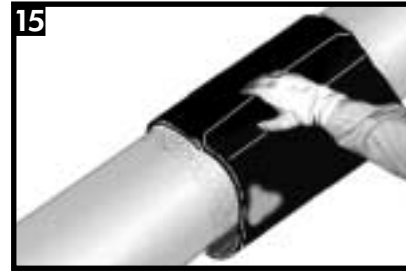

With the green-yellow coloured adhesive side facing down, firmly press the entire closure seal into place. Ensure that the closure is centred evenly over the underlap-overlap sleeve seam. If necessary, add additional heat to the closure underside in cold conditions, using a low flame intensity.



Gently heat the closure and pat it down with a gloved hand. Repeating this procedure, move from one side to the other. Smooth any wrinkles by gently working them outward from the centre of the closure with a roller.

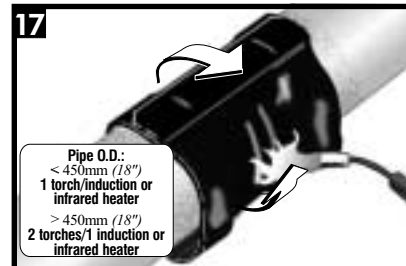

Using the appropriate sized torch, begin at the centre of the sleeve and heat circumferentially around the pipe. Use broad strokes. If utilizing two torches, operators should work on opposite sides of pipe.

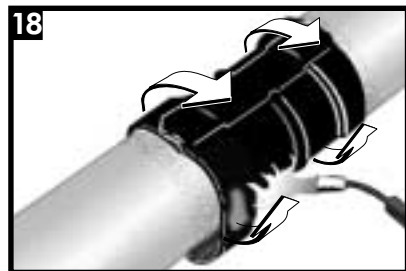

Continue heating from the centre toward one end of the sleeve until recovery is complete. In a similar manner, heat and shrink the remaining side.

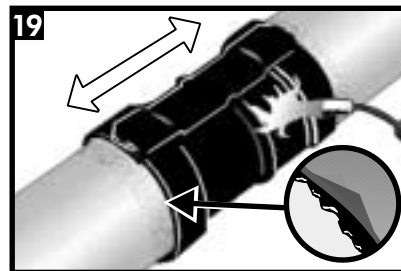

Shrinking has been completed when the adhesive begins to ooze at the sleeve edges all around the circumference. Finish shrinking the sleeve with long horizontal strokes over the entire surface to ensure a uniform bond.

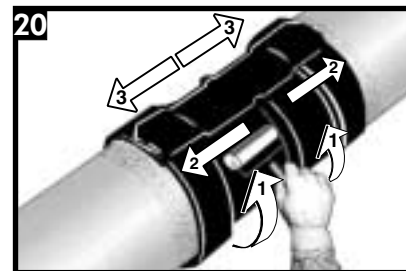

While the sleeve is still hot and soft, use a hand roller to gently roll the sleeve surface and push any trapped air up and out of the sleeve, as shown above. Continue the procedure by also firmly rolling the closure with long horizontal strokes from the weld outwards.

## Inspection

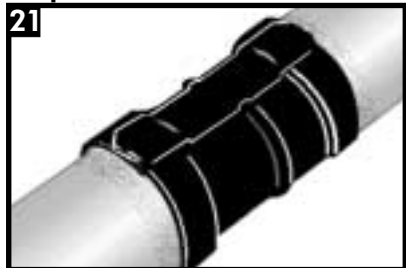

Visually inspect the installed sleeve for the following:

- Sleeve is in full contact with the steel joint.
- Adhesive flows beyond both sleeve edges.
- No cracks or holes in sleeve backing.

## Backfilling Guidelines

After shrinking is complete, allow the sleeve to cool for 2 hours prior to lowering and backfilling. To prevent damage to the sleeve, use selected backfill material, (no sharp stones or large particles) otherwise an extruded polyethylene mesh or other suitable shield should be used.



A SHAWCOR COMPANY

### Canada

CANUSA-CPS  
a division of SHAWCOR LTD.  
25 Bethridge Road  
Rexdale, Ontario  
M9W 1M7,  
Canada  
Tel: +1 (416) 743-7111  
Fax: +1 (416) 743-5927

### U.S.A./Latin America

CANUSA-CPS  
a division of SHAWCOR INC.  
2408 Timberloch Place  
Building C-8  
The Woodlands, Texas  
77380, U.S.A.  
Tel: +1 (281) 367-8866  
Fax: +1 (281) 367-4304

### Europe/Middle East

CANUSA-CPS  
a division of Canusa Systems Ltd.  
Unit 3, Sterling Park  
Gatwick Road  
Crawley, West Sussex  
England RH10 9QT  
Tel: +44 (1293) 541254  
Fax: +44 (1293) 541777

### Asia/Pacific

CANUSA-CPS  
BrederoShaw (S) Pte Ltd  
101 Thomson Road  
#17-01/02, United Square  
Singapore  
307591  
Tel: +65-6732-2355  
Fax: +65-6732-9073